

SUPER DUTY NON-INSULATED TRANSPORT CABINET MODEL 101-1820-DSD

FEATURES AND BENEFITS:

- Non-insulated super duty all purpose cabinet for rough handling during transport.
- Same size top and base extend past sidewall to act as natural bumpers for protection. Extruded frame fully welded.
- Body constructed of specially reinforced non-corrosive, Hi-Tensile aluminum for extra strength.
- Double reinforced, full length door swings 270° and can be latched to the cabinet side for convenience. Card clip included.
- Gravity type latch secures door during transport.
- Heavy duty hinges.
- Extruded angle ledge pan supports hold 18" x 26" pans or 14" x 18" trays on 3" centers.
- Interior pan stops on back allow proper air flow.
- Heavy duty 5" swivel casters, two with brakes. Provides mobility when fully loaded.



101-1820-DSD



ACCESSORIES and OPTIONS

(Available at extra cost):

- Lock Hasp
- Various Caster Options
- Corner Bumpers
- Perimeter Bumper
- Floor Lock (for use with 5" casters)
- Push Handle
- Bail Handle Kit
- Left-Hand Hinged Door
- Kold Keepers

See page A-20 for accessory details.

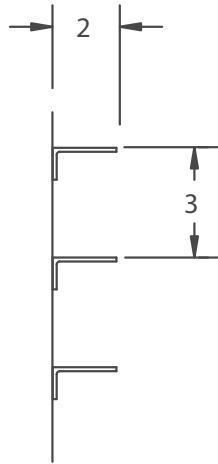

DETAIL OF PAN SLIDE

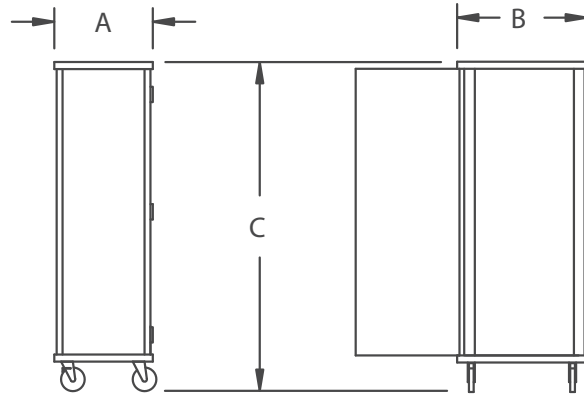
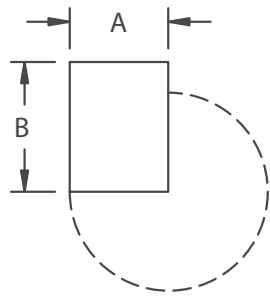

| CRES COR MODEL NO. | PAN | | | DIM "A" | DIM "B" | DIM "C" | INSIDE DIMENSIONS | | | | WEIGHT ACT. |
|--------------------|-----|-----------|----|---------|---------|---------|-------------------|--------|--------|-----|-------------|
| | CAP | SIZE | | WIDTH | DEPTH | HEIGHT | WIDTH | DEPTH | HEIGHT | | |
| 101-1820-DSD | 20 | 18 x 26 | IN | 21 | 31 | 69-3/4 | 18-3/16 | 28-1/2 | 61-1/2 | LBS | 160 |
| | | 460 x 660 | MM | 535 | 790 | 1775 | 465 | 725 | 1565 | KG | 73 |
| | 40 | 14 x 18 | IN | | | | | | | | |
| | | 360 x 460 | MM | | | | | | | | |

When ordering bumpers, add 2" to overall dimensions.

ALL ALUMINUM CONSTRUCTION IS RIVETED, WELDED AND FINISHED.

CABINET:

- Posts: Extruded channels, 7/8 x 2-1/4 x .102, welded to top and base, form a solid frame.
- Sides and back: .063 panels riveted to posts.
- SUPER DUTY back panel: Fitted into posts, riveted to top and reinforced with additional bracing.
- Tie rod: Two are applied at front.
- Top: One piece .100 aluminum.
- Pan stop channel: Mounted to inside rear of cabinet.

BASE:

- One piece construction, .190 aluminum.
- Casters: 5" dia., swivel, modulus tires, 1-1/4 wide, load cap. 250 lbs. each, temp. range -45°/+180° F. Delrin bearings. Front casters equipped with brakes.

DOOR:

- Panel: .063 aluminum, fitted into extruded frame, 3/4 x 1-7/16 x .187.
- SUPER DUTY reinforcement: Five 1/4 x 1-1/2 extruded bars riveted and welded horizontally
- Latch: Gravity type, nickel plated steel.
- Swings 270° on 3 heavy duty butt hinges, riveted to posts and frame.

PAN SLIDES:

- Extruded angle supports 1 x 2 x .125 riveted to sides on 3" centers.

SHORT FORM SPECIFICATIONS

Cres Cor Super Duty Cabinet Model 101-1820-DSD. Formed and welded .100 aluminum top, .190 aluminum base. Extruded aluminum angles, riveted on 3" centers. .063 aluminum door, full frame welded construction. Two additional extruded bars riveted and welded to door and back. 5" swivel modulus casters, Delrin bearings. Load capacity 250 lbs. each. Provide the following accessories: _____ . NSF listed. 2 year parts warranty.



5925 Heisley Road • Mentor, OH 44060-1833
 Phone: 877/CRESCOR • Fax: 440/350-7267
 www.crescor.com

© Crescent Metal Products, Inc. 2006 All rights reserved.

In line with its policy to continually improve its products, CRES COR reserves the right to change materials and specifications without notice.